



Shenzhen Ateess Power Technology Co.,Ltd

GROWATT-ATESS Industrial Park, No.23 Zhulongtian Road, Shuitian Community,  
Shiyan Street, Baoan District, Shenzhen

T + 86 755 2998 8492

E [info@atesspower.com](mailto:info@atesspower.com)

W [www.atesspower.com](http://www.atesspower.com)

Revised date:2023-02-27

## ATESS EVD-160D 160kW DC charging equipment user manual

## Copyright Notice

This user manual is copyrighted by Shenzhen ATESS Power Technology Co., Ltd. (hereinafter referred to as "ATESS Power Technology"). No unit or individual may extract or copy part or all of this user manual without the written permission of the company. Content must not be transmitted in any form, including materials and publications.

All rights reserved. ATESS Power Technology has the final interpretation of this user manual. The product specification may be updated from time to time and is subject to change without prior notice!

## Thank you for choosing ATESS charging equipment

ATESS EVC series intelligent DC charging equipment is a device that provides high-efficiency, safe and stable DC power supply for electric vehicles, which has a friendly man-machine interface and integrates corresponding functions of control, billing, communication and security protection. The charging equipment uses OCPP 1.6JSON open protocol for communication with back-office server, thus to realize functions such as reservation and network payment via mobile APP. Diversified communication options, including wired Ethernet, WIFI, 4G, wireless, are provided for customers to conveniently connect the device to a charging network. This product supports CCS. Each connector works independently. Up to 2 EV could be charged at the same time. All the above features make it most suitable for outdoor charging.

We sincerely hope that this product can meet your needs, and we welcome and value your feedback and suggestions on the performance and function of the product. We will continuously improve the quality of our products and services.

# Menu

I. Product description.....	1
II. Packaging list.....	3
III. Installation and wiring.....	3
IV. Parameter configuration	
4.1 System Parameters.....	7
4.2 Network parameters.....	8
4.3 Protection parameters.....	10
V. Operation instruction and LCD introduction	
5.1 Charging mode and operation.....	11
5.2 LCD interface introduction.....	13
5.3 Appendix: Fault code .....	15
VI. Specification .....	16
VII. Appendix	
7.1 Electric diagram .....	18
7.2 Warranty.....	19
7.3 Contact.....	20

# I. Product description

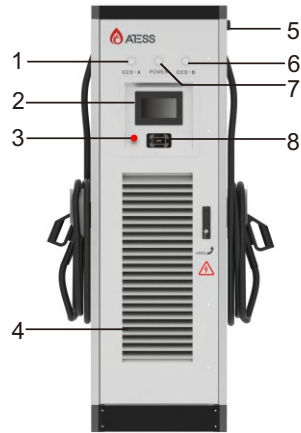

- 1. CCS-A connector indicator(charging yellow/fault red)
- 2. HMI
- 3. Emergency stop button
- 4. Air inlet
- 5. WIFI/4G antenna
- 6. CCS-B connector indicator(charging yellow/fault red)
- 7. Power indicator
- 8. RFID reader

## Internal view and terminal definition



Crimp the below shown ring terminals on the end of the AC input wires and PE wires.  
 Connect the wires into the terminal block of the chargepoint as below.  
 Check the wiring then close the switch and the door.

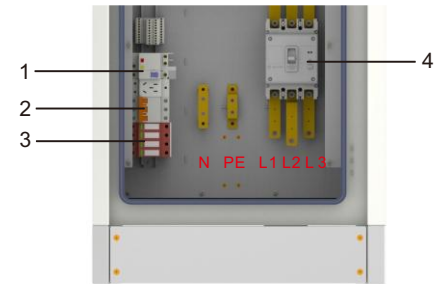

- 1.Auxiliary power control breaker;
- 2.Breaker in surge protection circuit;
- 3.SPD
- 4.Main power control breaker;
- 5.AC input terminal block. Terminal definition is (N PE L1 L2 L3) from left to right;



Fig: AC Surge protection device

Note: The charging equipment will detect the current status of the lightning arrester module in real time. When the lightning protection module is damaged, the display will have an alarm indicating that the lightning protection device is faulty. When repairing and replacing the lightning protection module. Then the maintenance person can operate the breaker in the surge protection circuit and replace the lightning protection module.(The red circle in the figure is the lightning protection status indicator. When the indication window indicates green, the lightning protection module is normal; when the indication window indicates red, the lightning protection module has been broken and damaged, and the lightning protection module needs to be replaced.)

## II. Packaging list

No.	Items	Qty	Remark
1	charging equipment	1	
2	User manual	1	
3	Certificate of quality	1	
4	User card	3	
5	Hexagon head bolt, all thread,M12*90/GB5783, Blue zinc plating	4	
6	Plain Washer,D12/GB97 1, Plated Blue Zinc	8	
7	Standard Spring Washer,D12/GB93, plated blue zinc	4	
8	Hexagon Nuts,M12/GB6170, Electroplated Blue Zinc	4	

## III. Installation and wiring

### 3.1 Installation conditions

1 ) keep a minimum clearance of 1.2m all around the charger, as follows:



2 ) The charger must be installed on a customized concrete foundation, the foundation is as below:

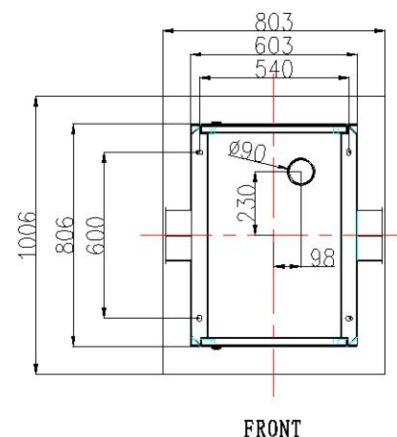
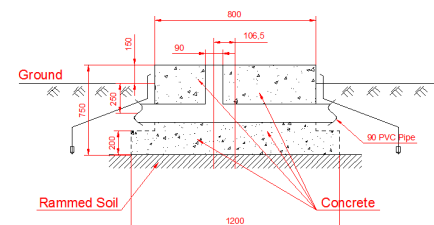

Concrete foundation diagram

Annotation:

- 1.The foundation pile must be tamped. On loose and moist soil, the foundation must be reinforced. The foundation must sit at the highest point of the area to avoid flooding water.
- 2.The foundation pile is to be made of reinforced concrete, which requires for a minimum allowable bearing pressure of 1000kg/squire meters for the base.
- 3.Construct main grounding busbar and electrode following the grounding regulation of transformer substation. Grounding resistance should be lower than $4\Omega$ , 50x4 galvanized flat steel is suggested.
4. Cable conduit uses PVG of 90mm diameter, the direction should be determined according to the situation on site, while the quantity is according to how many HV/LV cables will be used(use redundant design) .
- 5.Level bar should be used to level the foundation ground.
- 6.Internal foundation level should slightly lean towards water collecting pit.
- 7.The figure is just for reference.

3) The minimum height of foundation is 150mm above ground, the vertical inclination degree should be less than 5%.

### 3.2 Cable connection

Connect the buried three phase four wire AC cables to the input terminal of the charger with correct color order and phase sequence. The earth cable shall be connected to the grounding bar of the charger. Wiring illustration is shown in elow. Please notice: For safety, the charger must be grounded securely.

Connect the grounding bar of the charger to the equipotential bonding bar of the installation site. The grounding cable should be no less than 50mm<sup>2</sup>. Grounding resistance shall be less than 4Ω.



	L1	L2	L3	N	PE
Terminal					
Wire	≥95mm <sup>2</sup> ≥AWG3/0	≥95mm <sup>2</sup> ≥AWG3/0	≥95mm <sup>2</sup> ≥AWG3/0	≥95mm <sup>2</sup> ≥AWG3/0	≥50mm <sup>2</sup> ≥AWG1/0

Notice :

1. Only professional personnel can do the wiring, connect the AC input wires in correct phase order according to the markings on the terminal block.
2. The PE terminal shall be connected to the Earth firmly and reliably.
3. No live work! Turn off the upstream breaker in the distribution panel and the breaker inside the charging equipment before repairing or maintaining.
4. Please do no disassemble the unit unless authorized.

## IV. Parameter configuration

After installed and connected, the charging equipment must first be configured according to the actual needs of the user. The parameters are configured through the LCD touch screen. Save the change and exit then the charging equipment can be used normally.

### Welcome to use DC charger

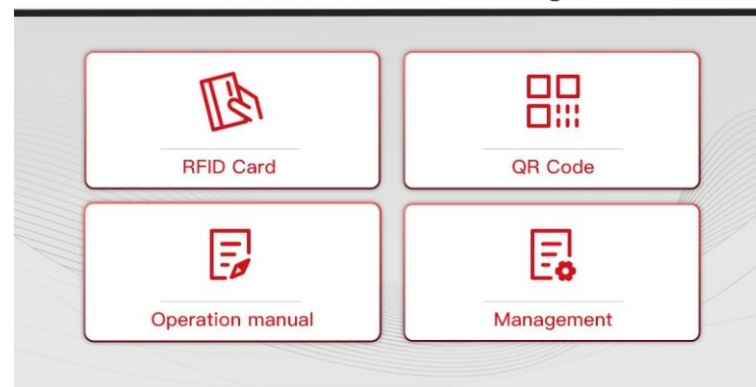

After the system enters standby, click the button marked by the red rectangle in the above figure to enter the system management page, as shown below.

### Management

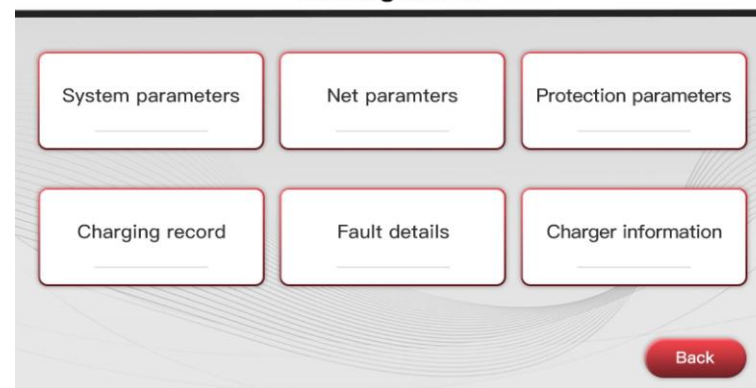

System management page

## 4.1 System Parameters

**System parameters**

System Parameters page

No.	Parameters	Function description
8	Meter address	DC meter's modbus address(already preset in factory, it is not allowed to modify)
9	Language set	Language setting. Currently support Thai-English and Thai-Chinese dual language display.
10	Time set	System time setting. Format is Y, M, D, H, M, S. The Year setting can only set the last 2 digits, e.g. use 19 for 2019.
11	Password set	Password of management page. It's a 4-digit fixed length password, default is "1234".

After changing parameters, click the "Set" button to save the setting, then click the "Back" button for the setting to take effect.

No.	Parameters	Function description
1	RFID Card PIN CODE	PIN code setting of RFID reader, a 6-digit code, the default setting is 242007. It must be the same with the PIN code of user card. Users can also use other PIN code if they have card writer to change PIN code of user card.
2	Tariff rate	Charging tariff setting, used to set the price per kWh.
3	Charge ID	Charger ID, suggested to use serial number as charger ID.
4	Charging station ID	Identification number of charging station. (one charging station may consist of multiple charging equipment).
5	Number of power modules	Number of power modules inside the mode 4 charging equipment.
6	Modules power	Rated power setting of power module
7	Plug and Charging	Charging mode setting. 1 is Plug&charge mode, payment is not needed; 2 is APP or RFID mode.

## 4.2 Network parameters

Network parameters need to be configured when the charging station needs to be connected to back office server for operation and management. Network parameters include server parameters and charger parameters. Currently the charging equipment support LAN connection, WIFI/4G.

**Network parameters**

No.	Parameters	Function description
1	Server URL1	Server address setting, used to set domain or IP address of back-office server.
2	Server URL2	Address of backup server. This parameter is not available now, reserved for future use.
3	Charger IP	IP setting of the charging equipment
4	Subnet mask	Subnet mask setting
5	Gateway	Gateway setting
6	DNS	DNS server address
7	MAC Addr	MAC address
8	Server IP	Server IP address
9	Server port	Server port number
10	WIFI SSID	WIFI SSID setting, to set the name of the wireless network to which the charging equipment is to be connected. A reserved function for future use
11	WIFI Key	WiFi password setting. A reserved function for future use
12	Authentication Key	OCPP login authentication setting

If the charger is connected to the server through the network cable, the Charger IP, Subnet mask and Gateway need to be set. Through WiFi, you need to set WiFi SSID and WiFi Key. With 4G, you can connect to the server by installing a SIM card.

### 4.3 Protection parameters

The protection-related parameters, such as voltage, current, temperature, power, etc.

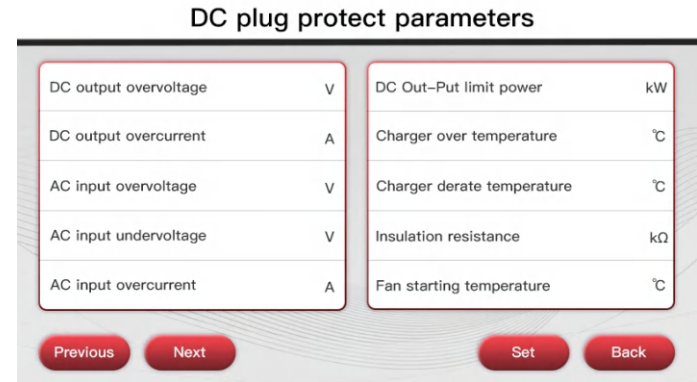

No.	Parameters	Function description
1	DC output overvoltage value	Over voltage limit setting of DC output
2	DC output overcurrent value	Over current limit setting of DC output
3	AC input overvoltage value	Over voltage limit setting of AC input
4	AC input undervoltage value	Under voltage limit setting of AC input
5	AC input overcurrent value	Over current limit setting of AC input
6	DC output limit power	Power limitation setting of DC output
7	Charger over temperature value	Over temperature limit setting of charging connector
8	Charger derate temperature value	Charging connector's temperature at which the charging equipment starts decreasing output power
9	Insulation Resistance	The min value of insulation resistance



## 4.4 Plug type

There are CCS two plugs optional.

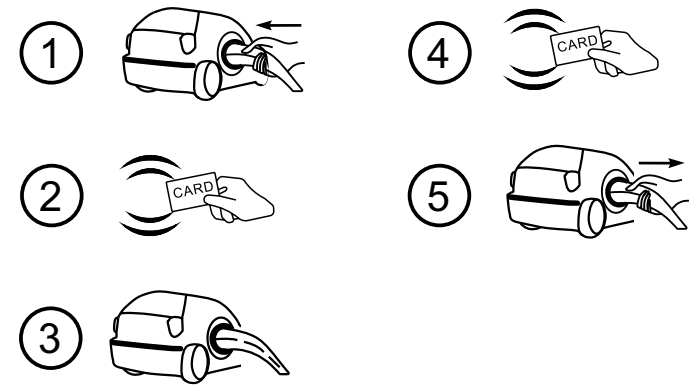
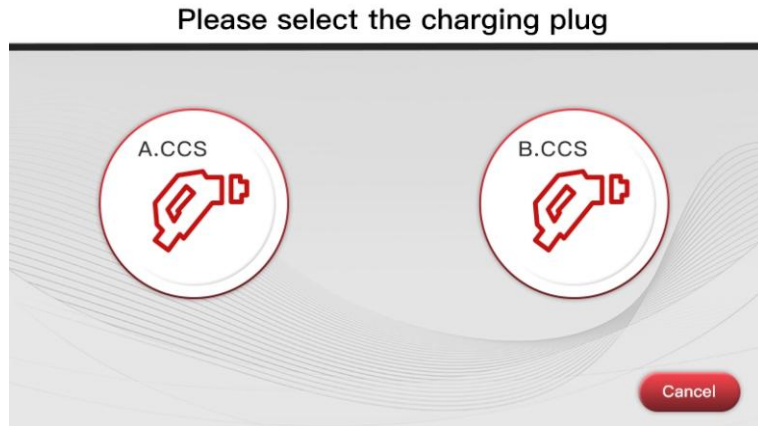

APP/RFID mode operation process flow

## V. Operation instruction and LCD introduction

### 5.1 Charging mode and operation

#### APP/RFID mode:

Initiate or cease charging by scanning QR code using APP or by swiping RFID card.

You can also use APP for reservation and payment provided that the back-office server supports such function;



#### Plug&Charge :

Charging will start automatically after EV plugged in. If you want to stop the charging, just press the stop icon on the screen.

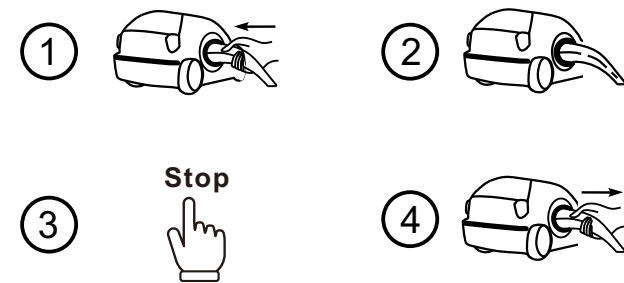

Plug&Charge mode operation process flow

## 5.2 LCD interface introduction

The charging equipment is equipped with a 7 inch industrial-grade resistor type touch panel. The display content is as below,

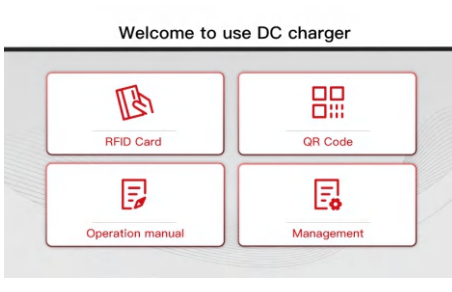
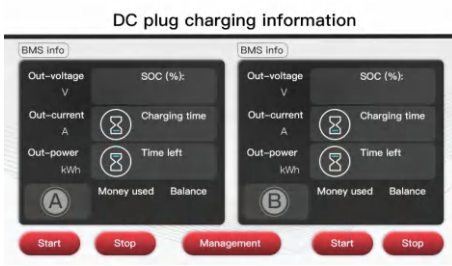
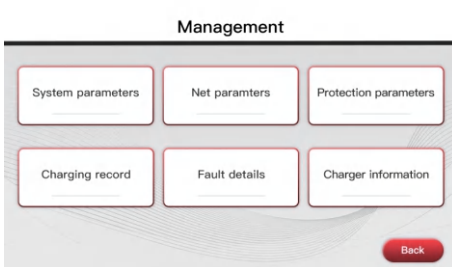
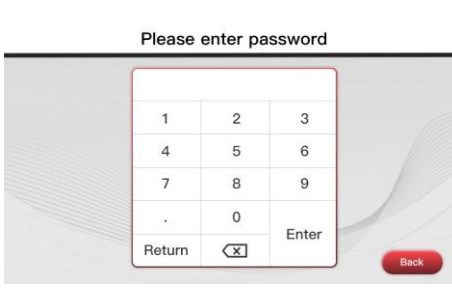
	<p>When powered up, the charging equipment will show this display,</p>
	<p>Charging information, which will show the status of the charging equipment, such as standby, charging, fault, etc.</p>
	<p>Management page, user can set different kinds of parameters here. Password authentication is required when entering each parameter setting page.</p>
	<p>Password window. Before entering numeric, please first press the text display field to move the cursor there, then you can type in the 4-digit password. A wrong password will cause no response and action.</p>

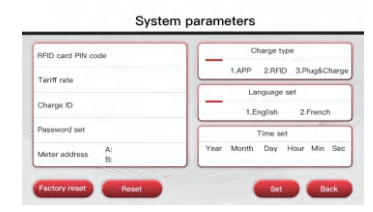
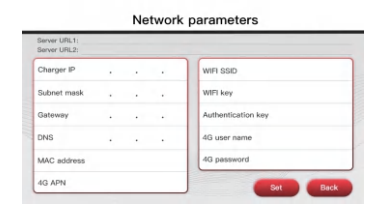
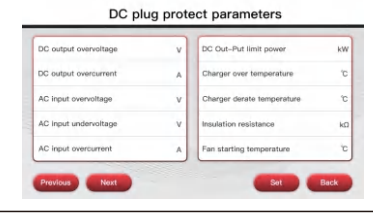
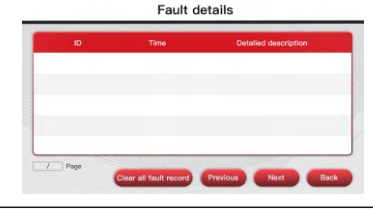
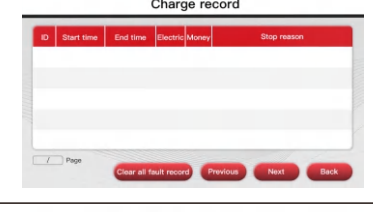
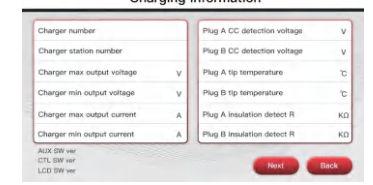
	<p>System parameters page.</p>
	<p>Network parameters page, used to set network related parameters of back-office server and the charging equipment.</p>
	<p>Protection parameters page of DC output, used to set limit value of voltage, current, power, temperature, etc.</p>
	<p>Fault record page, user can check history fault record here.</p>
	<p>Charging record page.</p>
	<p>Charging information page, to check real-time charging parameters.</p>

### 5.3 Appendix: Fault code

No.	Fault description
1	Emergency stop is pressed!
2	RFID communication fault!
3	Over temperature fault!
4	Lightning protection fault!
5	Power module communication fault!
6	Meter communication fault!
7	DC output overvoltage fault!
8	DC output overcurrent fault!
9	Waiting for BMS communication timeout!
10	Insulation detection timeout!
11	Insulation detection fault!
12	Battery voltage reverse fault!
13	DC+ Contactor sticking fault!
14	DC- Contactor sticking fault!
15	Plug line disconnection fault!
16	Plug head connection over temperature fault!
17	AC Contactor sticking fault!
18	AC Input Overvoltage!
19	AC Input Undervoltage!
20	BMS communication fault!

## VI. Specification

Model	EVD-160D
Dimension(mm)	1885*780*800(W*H*D)
Weight(kg)	337KG
Display	LCD
Casing material	Stainless steel&acrylic sheet
AC input	
Grid connection	400V, 3 phase 5 wires
Voltage	AC 320~457V
Current	250A
Frequency	50Hz
DC output	
Plug type	CCS
Voltage	DC150~1000V
Current	0-200A
Voltage-stabilizing accuracy	< ±0.5%
Current-stabilizing accuracy	< ±1%
Power factor	≥0.98
Efficiency	≥94%

IP degreeel	IP54
Working environment	-25°C~50°C
Relative humidity	<95%
Altitude	≤2000m, derate for higher than 2000m
Cooling method	Forced air cooling
Remote monitoring	Ethernet/WIFI/4G/485/232
Payment	RFID/APP
Standby power	100W
Standards	IEC-62196-2;EN61851
Mounting	Ground
Certificate	CE
Metering accuracy	0.5
Protection features	
Over /Under voltage t of AC output	YES
Over voltage of DC output	YES
Over temperature protection	Derate since 50°C; Stop at 75°C
Short circuit protection	YES
Emergency stop protection	YES
Leakage protection	Type A
Lightning protection	Type II

7.1 Electric diagram

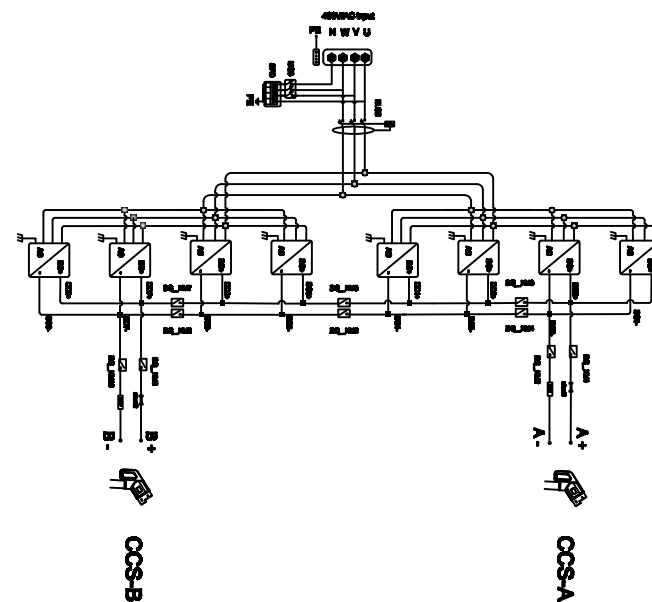

Fig7-1, Main circuit diagram

## 7.2 Warranty

### Warranty period

The warranty period of this product is 1 year. If the contract stipulates otherwise, the contract shall prevail.

For warranty cases during the warranty period, the customer should present the invoice of the purchase of the product to the service personnel of ATESS Power Technology. At the same time, the nameplate on the product should be clearly visible, otherwise the warranty claim might not be accepted.

### Warranty condition

ATESS Power Technology Co., Ltd. will repair or replace the product free of charge during the warranty period. The defective machine after replacement shall be owned by ATESS Power Technology, and the customer shall reserve a certain amount of time for ATESS Power Technology to repair the faulty machine.

### Liability exemption

ATESS Power Technology reserves the right not to accept the warranty claim if the conditions below happen,

- 1.No ATESS logo on the product;
- 2.Warranty period has expired;
- 3.Fault or damage caused by incorrect installation, by installing the device in a not allowed environment, by improper storage or usage, etc.(e.g. too high or too low temperature, moisture or too dry environment, high altitude or unstable voltage/current, etc.)
- 4.Failure or damage caused by the installation, repair, modification or disassembly by unauthorized service personnel;
- 5.Failure or damage caused by using ATESS Power Technology's genuine spare parts;
- 6.Damage or damage caused by accident or human cause (operational error, scratching, handling, bumping, access to inappropriate voltage, etc.), or transport damage;
- 7.Failure or damage caused by force majeure such as natural disasters (such as earthquakes, lightning strikes, fires, etc.);
- 8.Other failures or damages that are not caused by quality problem of the product or its components.

### Statement of liability

The copyright of this manual belongs to Shenzhen ATESS Power Technology Co., Ltd. Any organization or individual may not extract or copy part or all of the contents of this manual without any written permission from ATESS Power Technology, and may not be reproduced and spread in any form (including materials and publications). ATESS Power Technology Co., Ltd. has the final right to interpret this manual. This manual is subject to change without prior notice. For more information, please access [www.atesspower.com](http://www.atesspower.com).

## 7.3 Contact

Company Name: Shenzhen ATESS Power Technology Co., Ltd

Address: GROWATT-ATESS Industrial Park, No.23 Zhulongtian Road, Shuitian Community, Shiyan Street, Baoan District, Shenzhen

Website: [www.atesspower.com](http://www.atesspower.com)

Service line: +8675529988492

E-mail: [info@atesspower.com](mailto:info@atesspower.com)